

Historische Wanddecoration eines Türringels Weinkellers.

Architekt: G. Schöberle. Proj. in Karlsruhe.

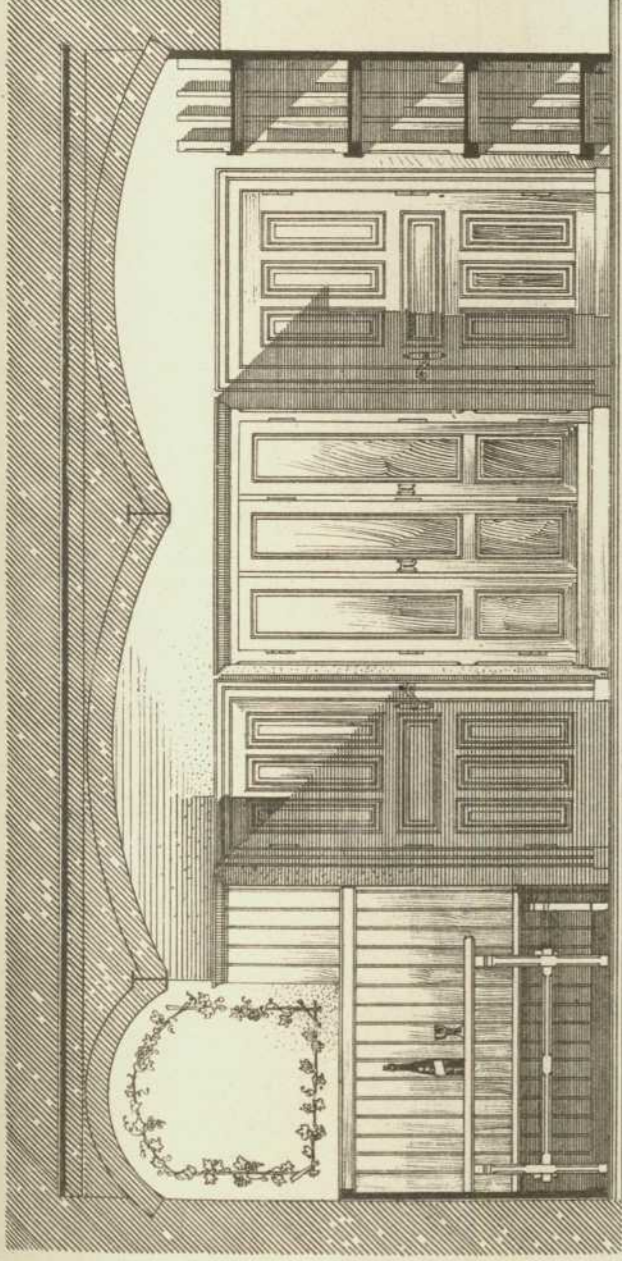

Wand-D.

Weinkeller  
im  
Haus v. Fr. Förster  
in  
Tübingen  
Architekt.  
Otto Mersch  
Kgl. Baubeamt. in  
Charlottenburg.

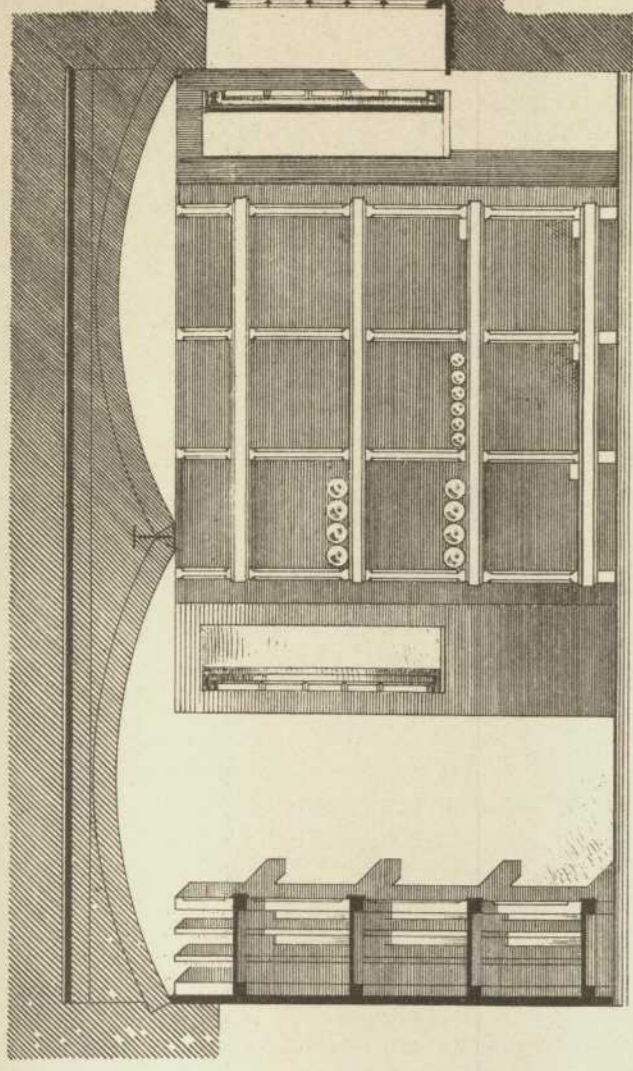

Wand-C.

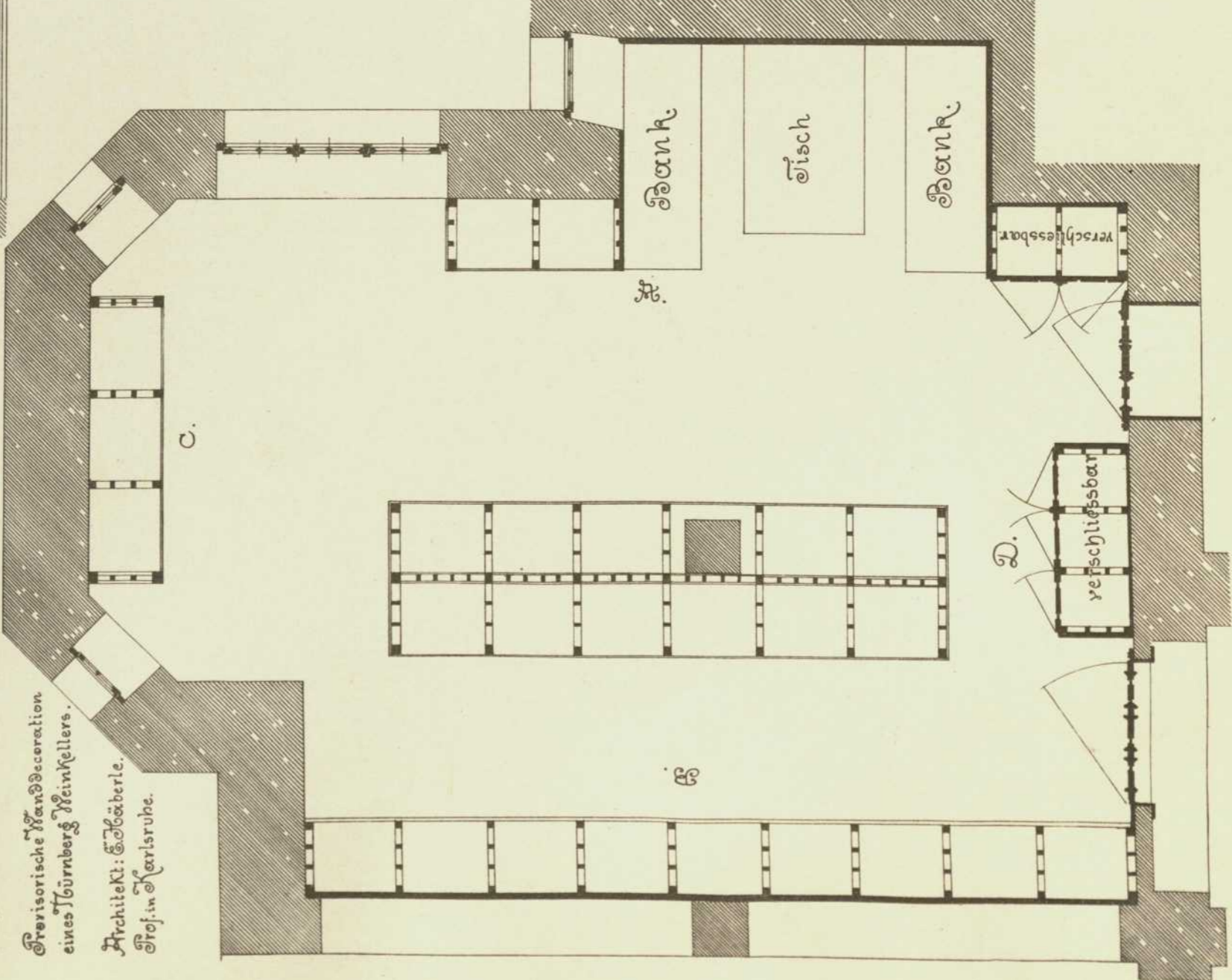

C.

B.

A.

Wand

Tisch

Wand

verschließbar

verschließbar

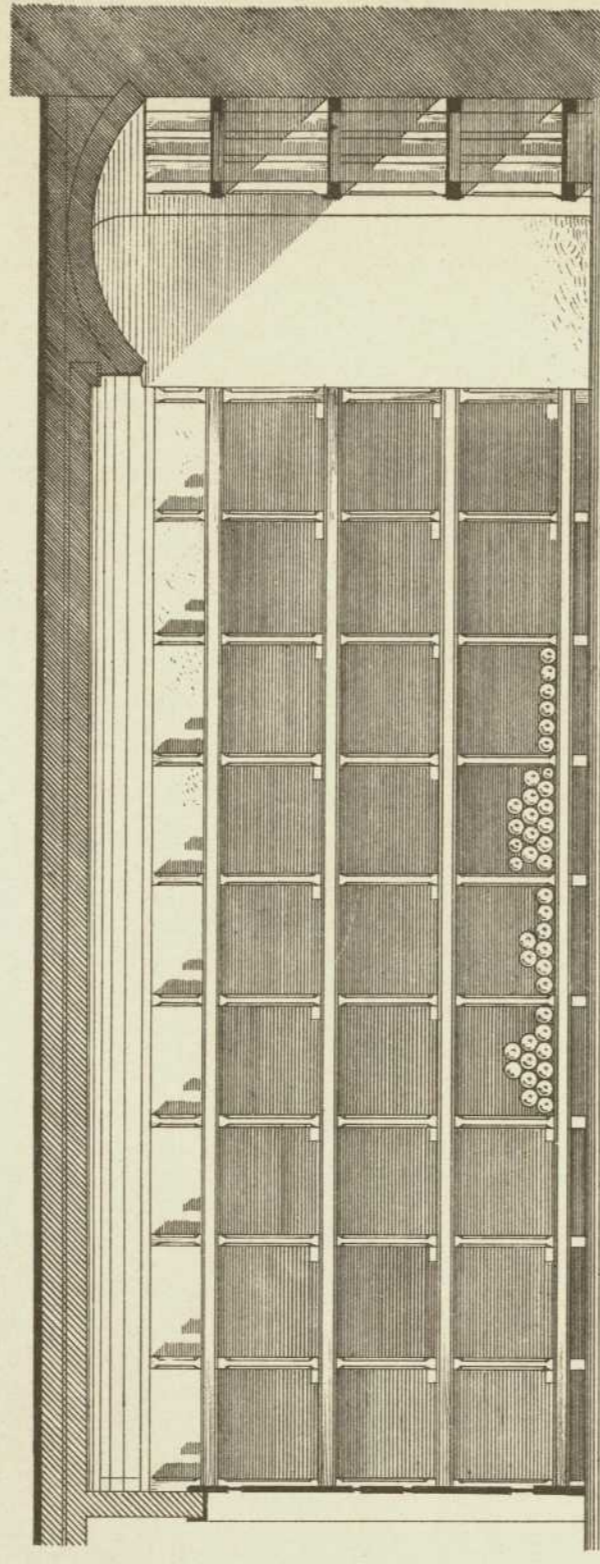

Wand-E.

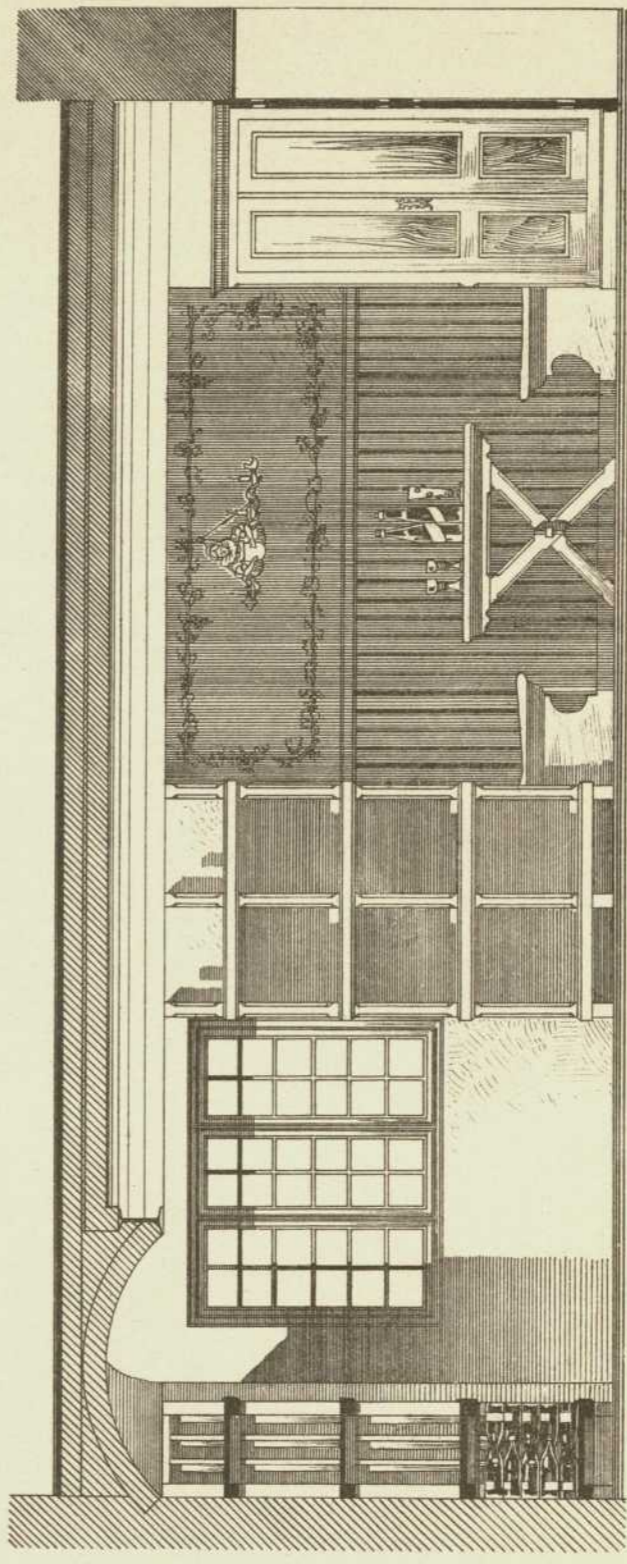

Wand-F.

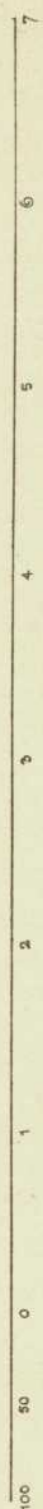

Verlag von Konrad Wittwer in Stuttgart.

Lith. Anst. v. A. Gattermicht.