

| | |
|---------------------------------|---|
| Persistenter Identifier: | 1544108690212 |
| Titel: | Der innere Ausbau des bürgerlichen Wohnhauses etc. |
| Autor: | Häberle, Ernst |
| Ort: | Stuttgart |
| Maße: | 100 Taf. in Mappe |
| Datierung: | 1898 |
| Signatur: | 1Kc 976 |
| Strukturtyp: | monograph |
| Lizenz: | https://creativecommons.org/licenses/by-sa/4.0/ |
| PURL: | https://digibus.ub.uni-stuttgart.de/viewer/image/1544108690212/1/ |
| Abschnitt: | Weinkeller im Hause Fr. Vorster zu Köln a. Rh. |
| Künstler/Illustrator: | March, Otto |
| Strukturtyp: | illustration |
| Lizenz: | https://creativecommons.org/licenses/by-sa/4.0/ |
| PURL: | https://digibus.ub.uni-stuttgart.de/viewer/image/1544108690212/64/LOG_0057/ |

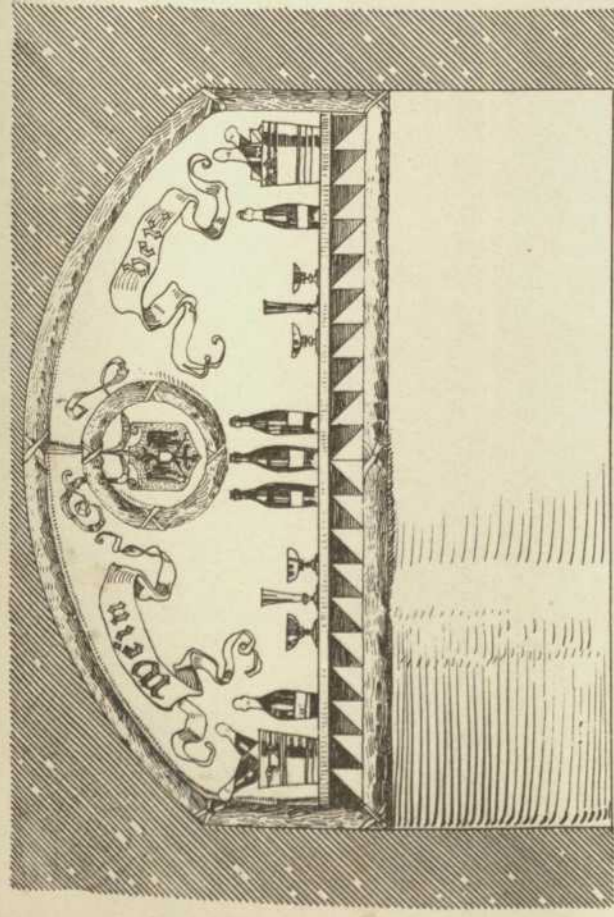

Historische Wanddecoration eines Weinbergs Weinkellers.

Architekt: G. Schöberle. Proj. in Stuttgart.

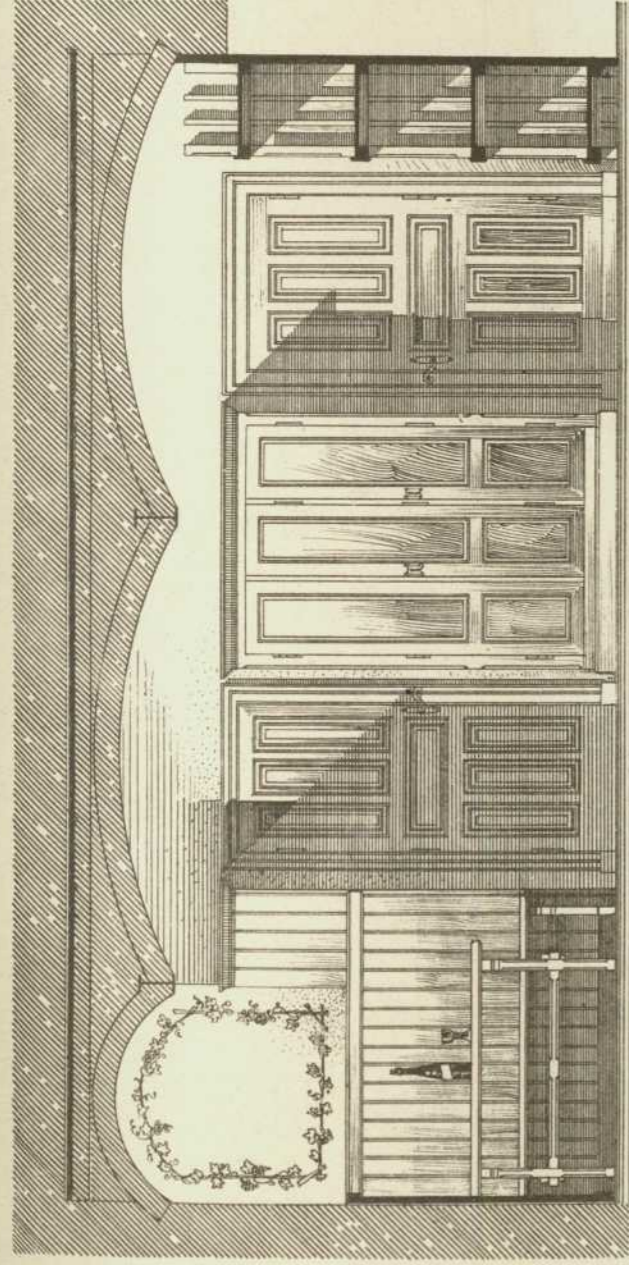

Wand-D.

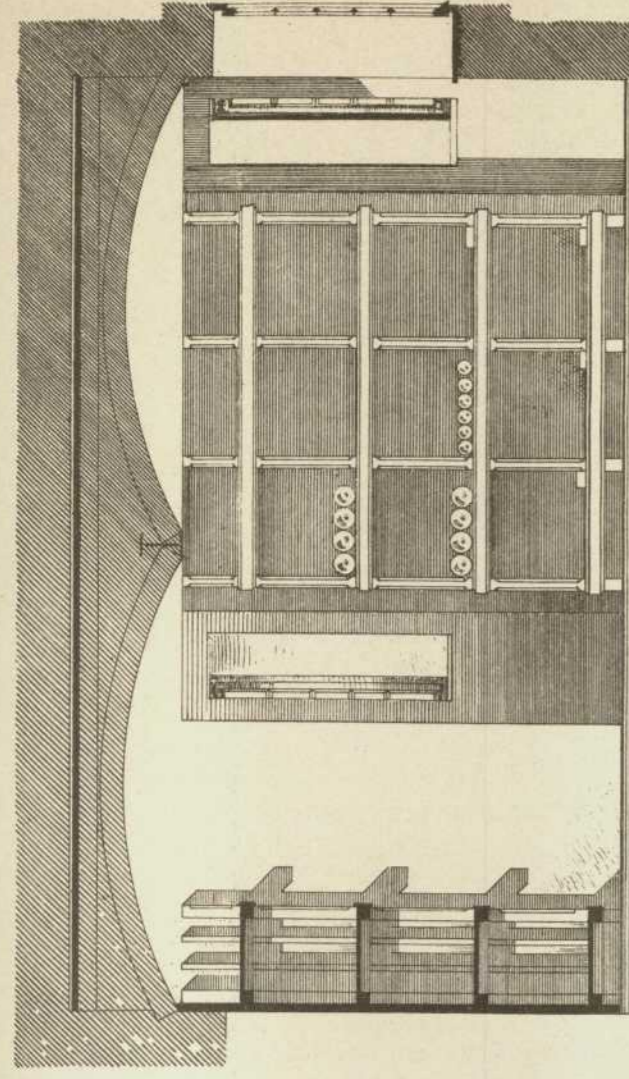

Wand-C.

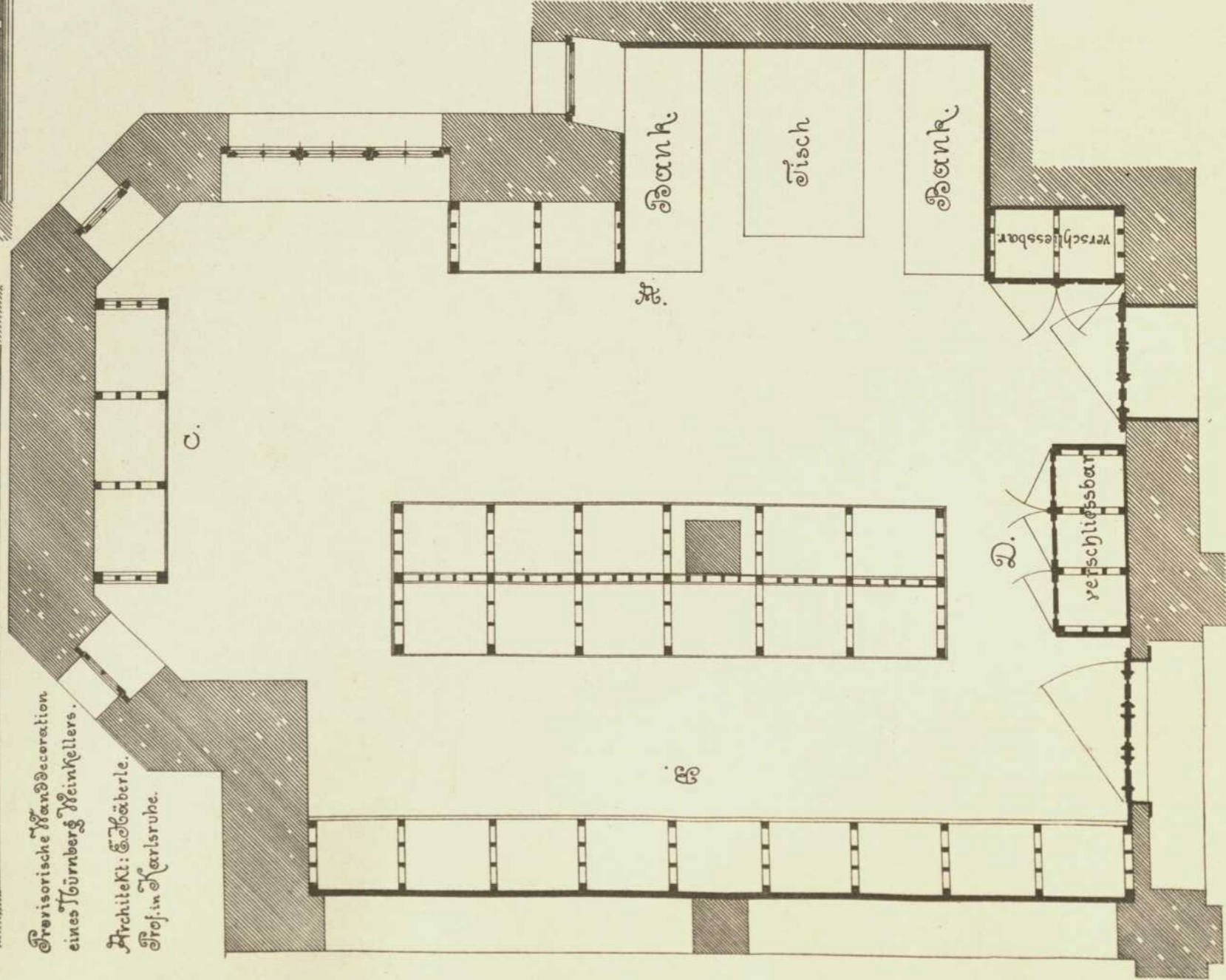

Weinkeller
im
Haus von Fr. Förster
in
Stuttgart.
Architekt:
Otto Mersch
Kgl. Bauingenieur in
Charlottenburg.

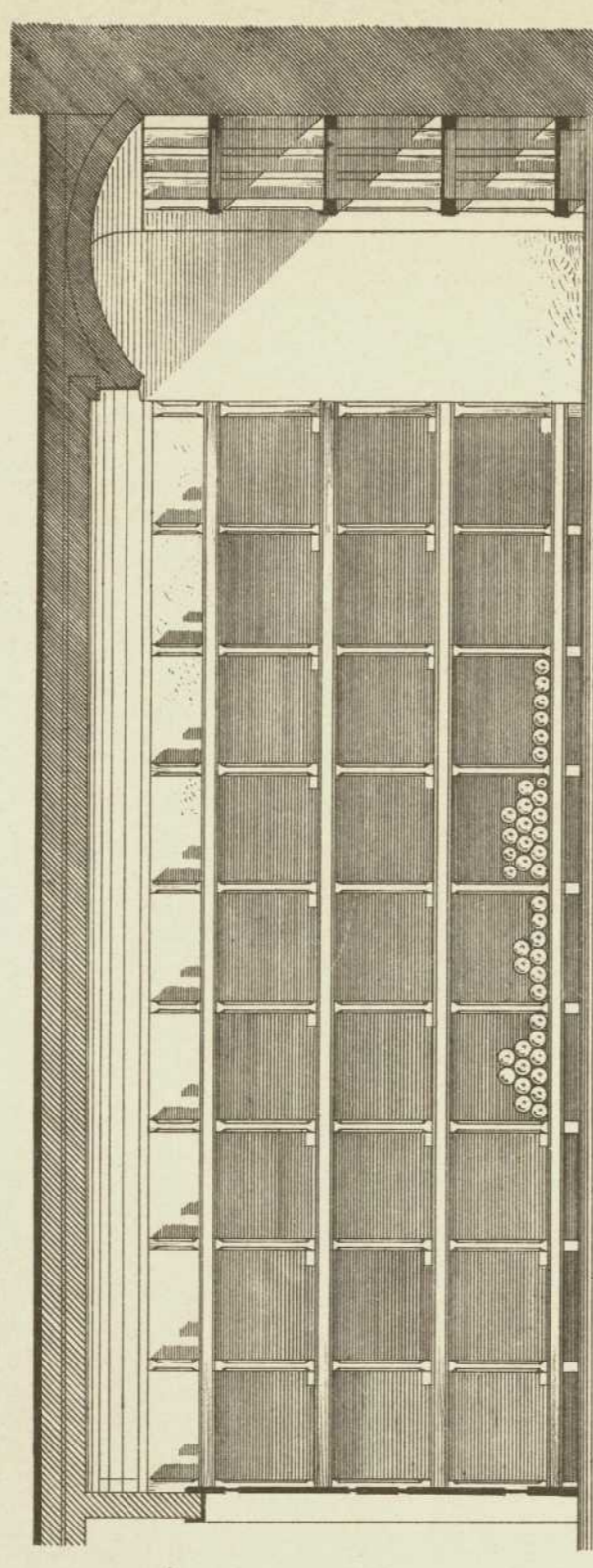

Wand-E.

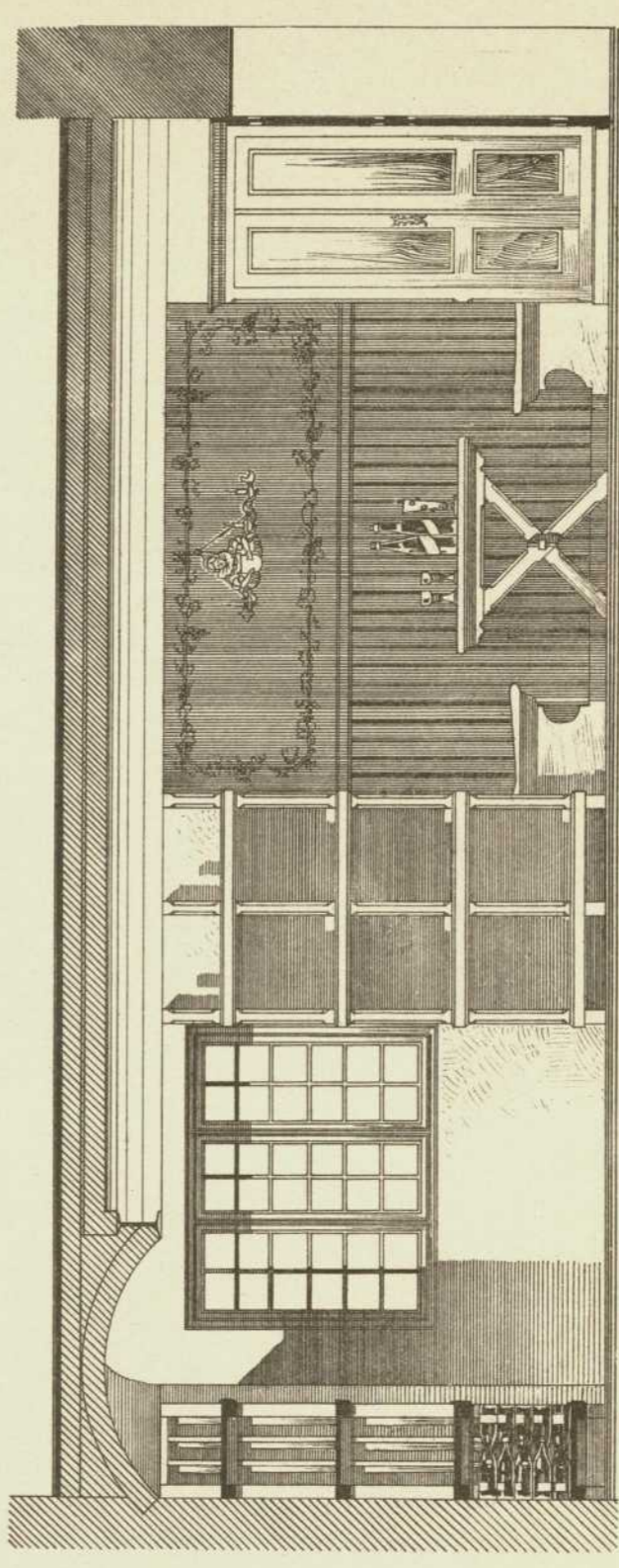

Wand-A.

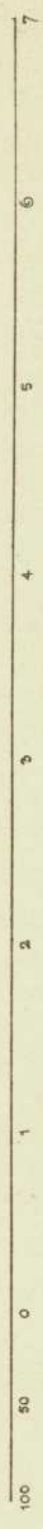

Verlag von Konrad Wittwer in Stuttgart.

Lith. Anst. v. A. Gattermicht.

VERLAG VON KONRAD WITTEWER IN STUTTGART.