

Persistenter Identifier: 1548316685127
Titel: Aufnahmen & Scizzen der Architectur-Schule in Rothenburg a.d.T.
unter W. Baeumer
Ort: Stuttgart
Maße: 31 Tafeln
Datierung: 1869
Signatur: 1Kb 694
Strukturtyp: monograph

Lizenz: <https://creativecommons.org/licenses/by-sa/4.0/>
PURL: <https://digibus.ub.uni-stuttgart.de/viewer/image/1548316685127/1/>

Abschnitt: Befestigungswerke aus Rothenburg o. T.
Künstler/Illustrator: Schill, Adolph
Beisbarth, Carl Friedrich Gottlob
Strukturtyp: illustration

Lizenz: <https://creativecommons.org/licenses/by-sa/4.0/>
PURL: [https://digibus.ub.uni-stuttgart.de/viewer/image/1548316685127/40/
LOG_0035/](https://digibus.ub.uni-stuttgart.de/viewer/image/1548316685127/40/LOG_0035/)

Befestigungswerke
aus
Rothenburg a/T

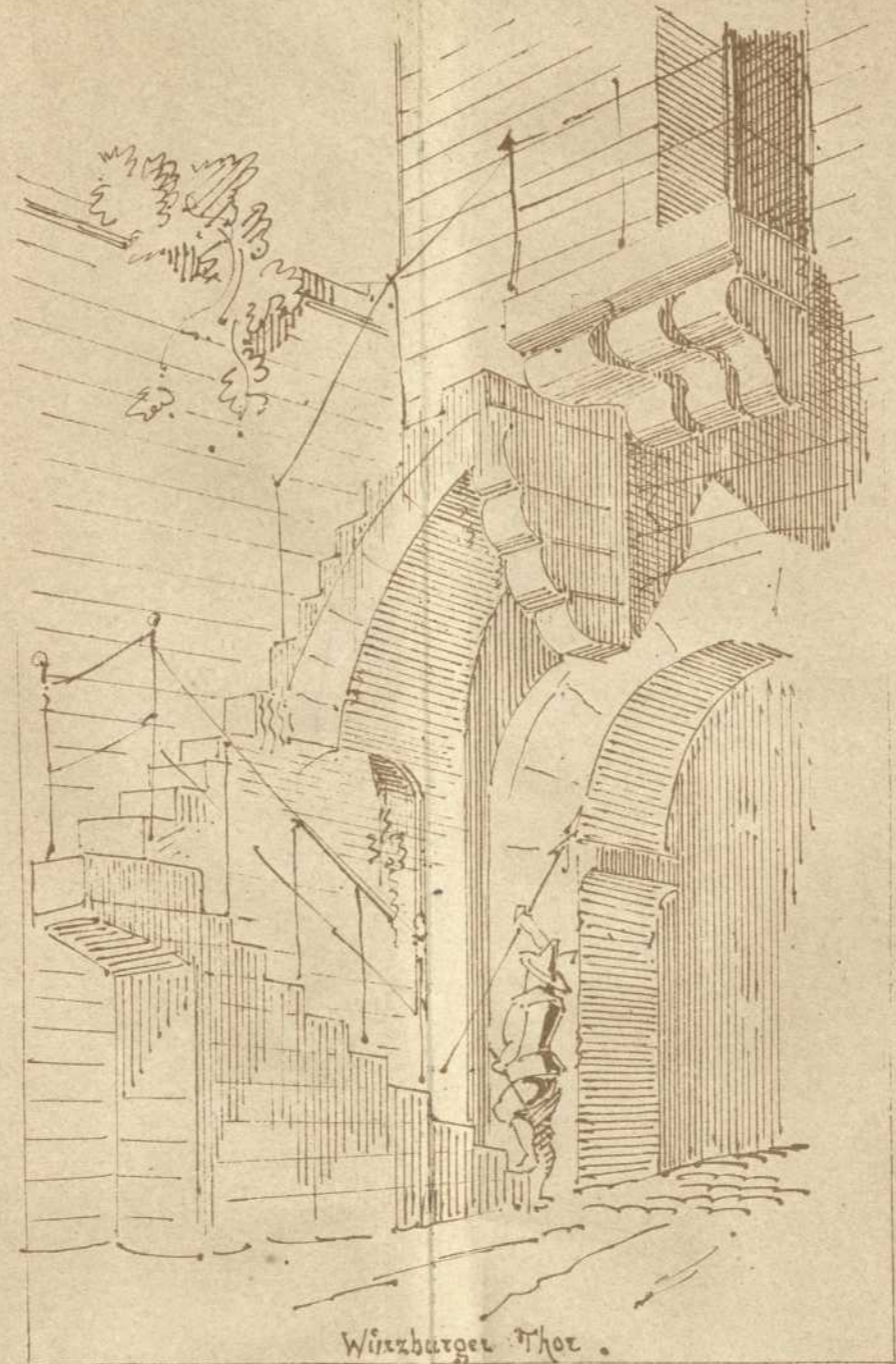
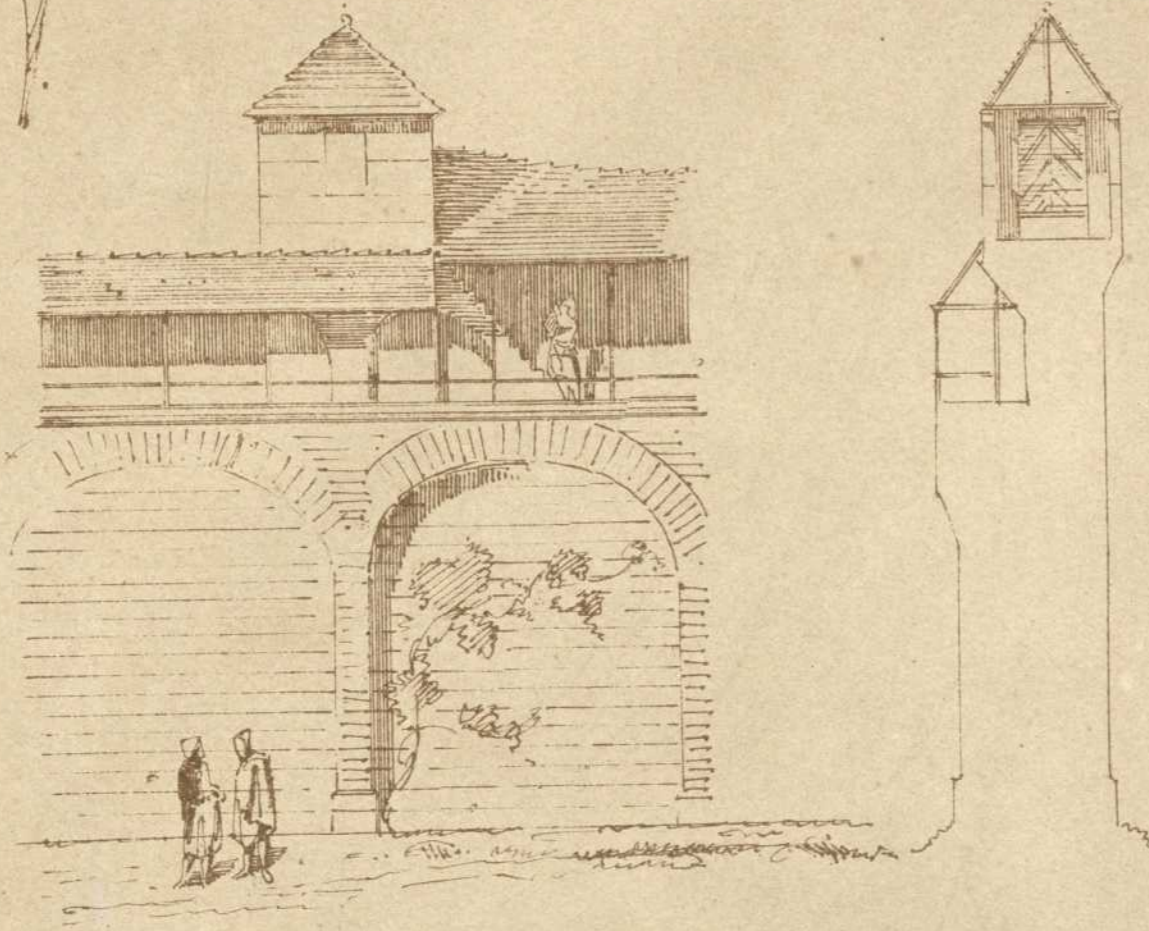

Witzbarger Thor.

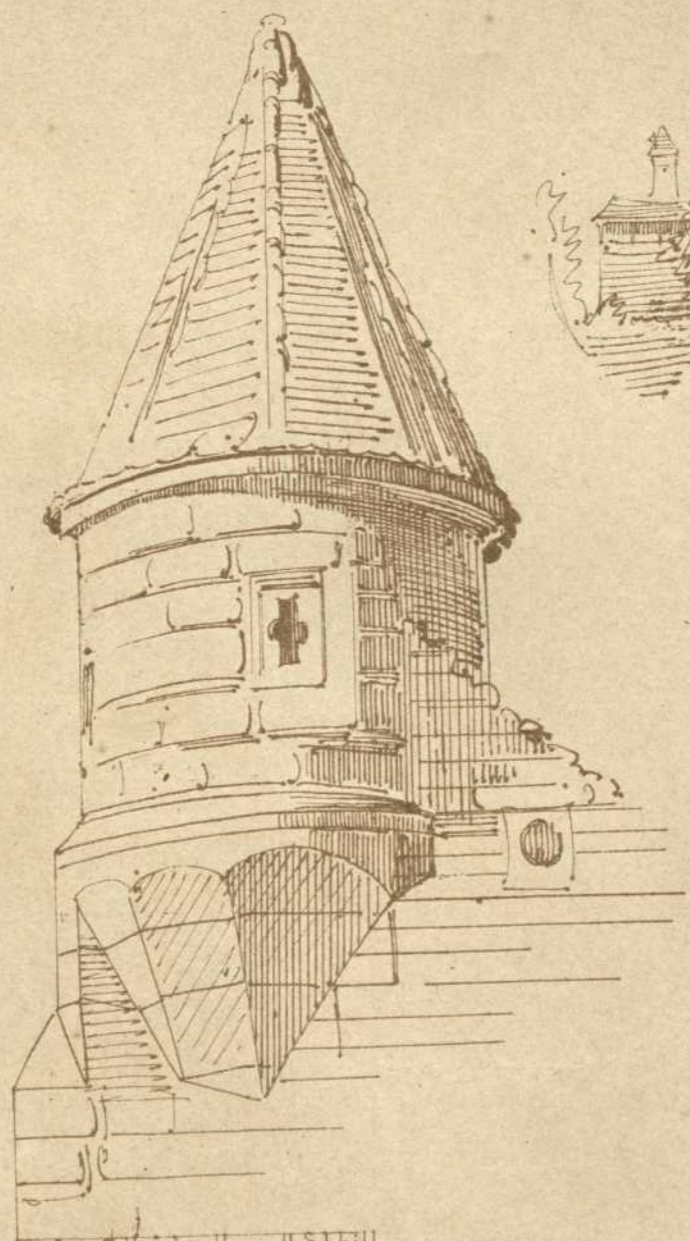

aufg. C. Heisbarth u. H. Sehill.

W. Bäumer dir.

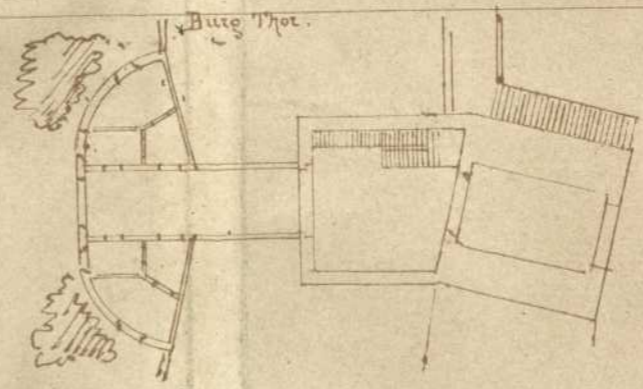
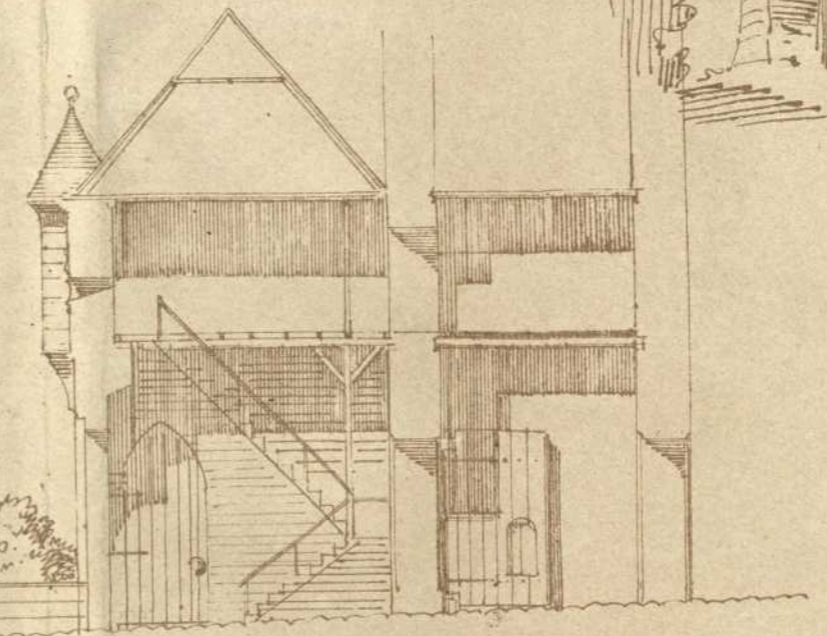

Druck u. Verlag v. Emil Hochdanz
in Stuttgart.

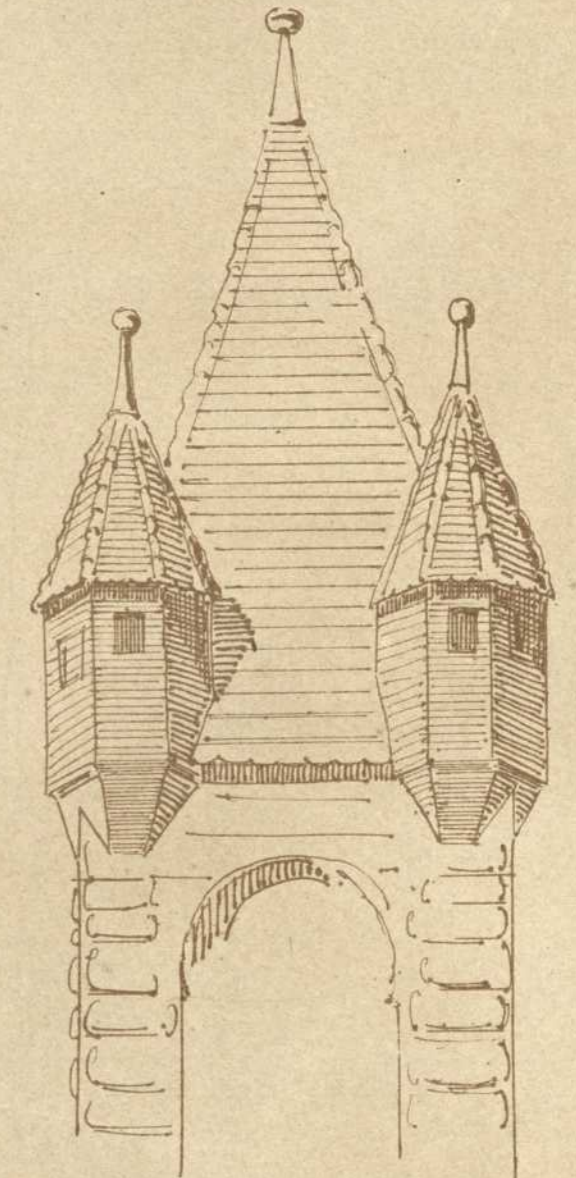

C. Heisbarth. a. u. b.
1869.