

---

**Persistenter Identifier:** 1560762353428

**Titel:** Architektur

**Autor:** Brantzky, Franz

**Ort:** Köln

**Maße:** 60 Bl.

**Datierung:** 1906

**Signatur:** 1Ka 1088

**Strukturtyp:** monograph

**Lizenz:** <https://creativecommons.org/licenses/by-sa/4.0/>

**PURL:** <https://digibus.ub.uni-stuttgart.de/viewer/image/1560762353428/1/>

**Abschnitt:** Entwurf zur St. Pauluskirche in Köln

**Künstler/Illustrator:** Brantzky, Franz

**Strukturtyp:** illustration

**Lizenz:** <https://creativecommons.org/licenses/by-sa/4.0/>

**PURL:** [https://digibus.ub.uni-stuttgart.de/viewer/image/1560762353428/54/LOG\\_0051/](https://digibus.ub.uni-stuttgart.de/viewer/image/1560762353428/54/LOG_0051/)



•FRONTE:LOTHR-STRASSE•

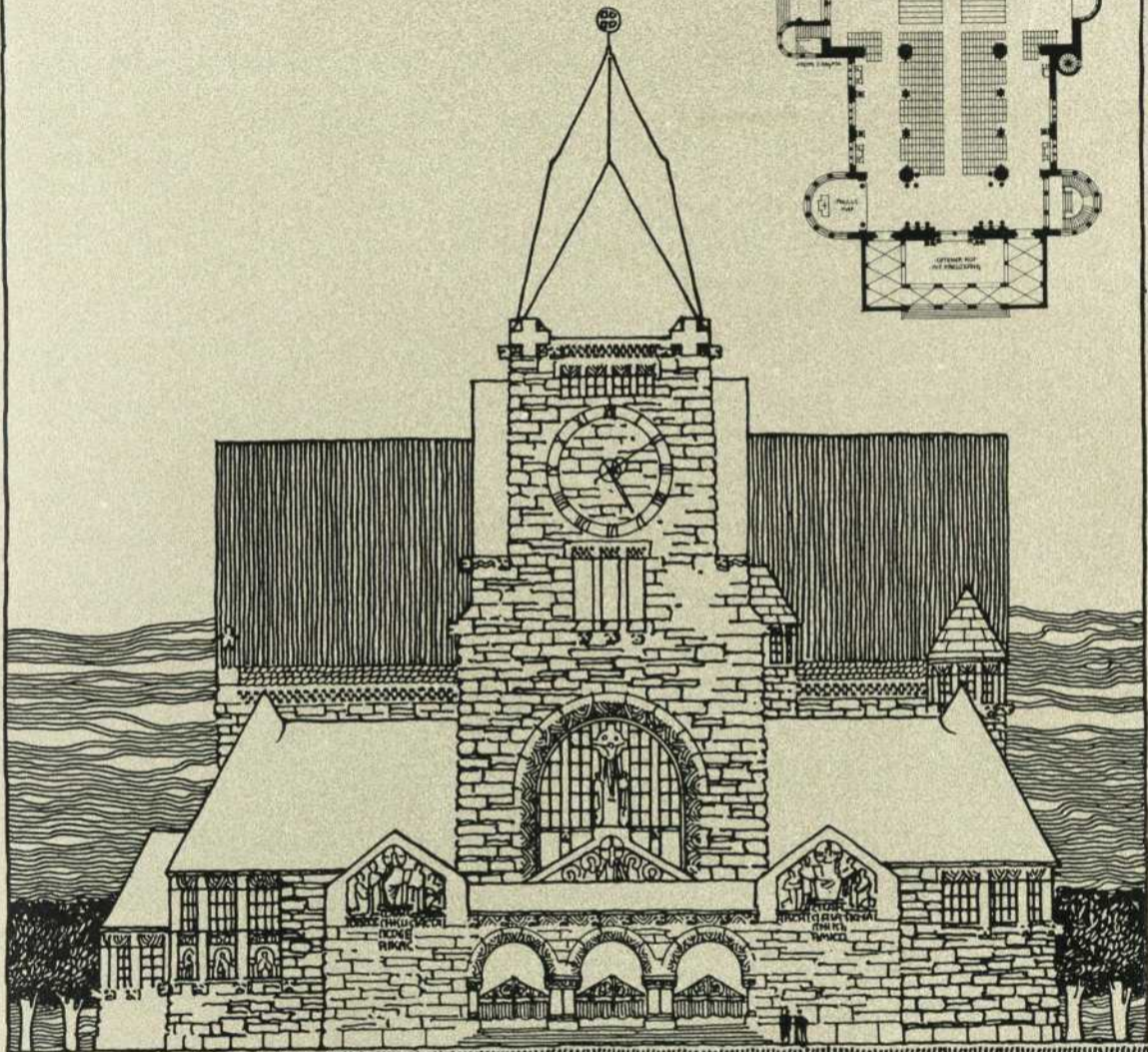
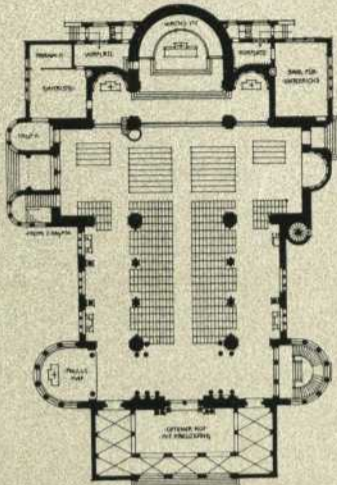

FRANZ BRANTZKY

ST. PAULUSKIRCHE KÖLN

FRANZ BRANTZKY  
-ARCHITEKTUR-