

- Persistenter Identifier:** 393080226_1889_1
- Titel:** Die Kunst- und Altertums-Denkmale im Königreich Württemberg.
Tafeln. Neckarkreis
- Autor:** Paulus, Eduard
- Ort:** Stuttgart
- Maße:** circa 100 Blätter Bildtafeln
- Datierung:** 1889
- Signatur:** 2Kb 939:a-Atlas,1
- Strukturtyp:** volume
- Lizenz:** <https://creativecommons.org/licenses/by-sa/4.0/>
- PURL:** https://digibus.ub.uni-stuttgart.de/viewer/image/393080226_1889_1/1/
- Abschnitt:** Liebfrauenkirche bei Lienzingen. Ansichten, Grundrisse.
- Strukturtyp:** illustration
- Lizenz:** <https://creativecommons.org/licenses/by-sa/4.0/>
- PURL:** https://digibus.ub.uni-stuttgart.de/viewer/image/393080226_1889_1/96/LOG_0094/

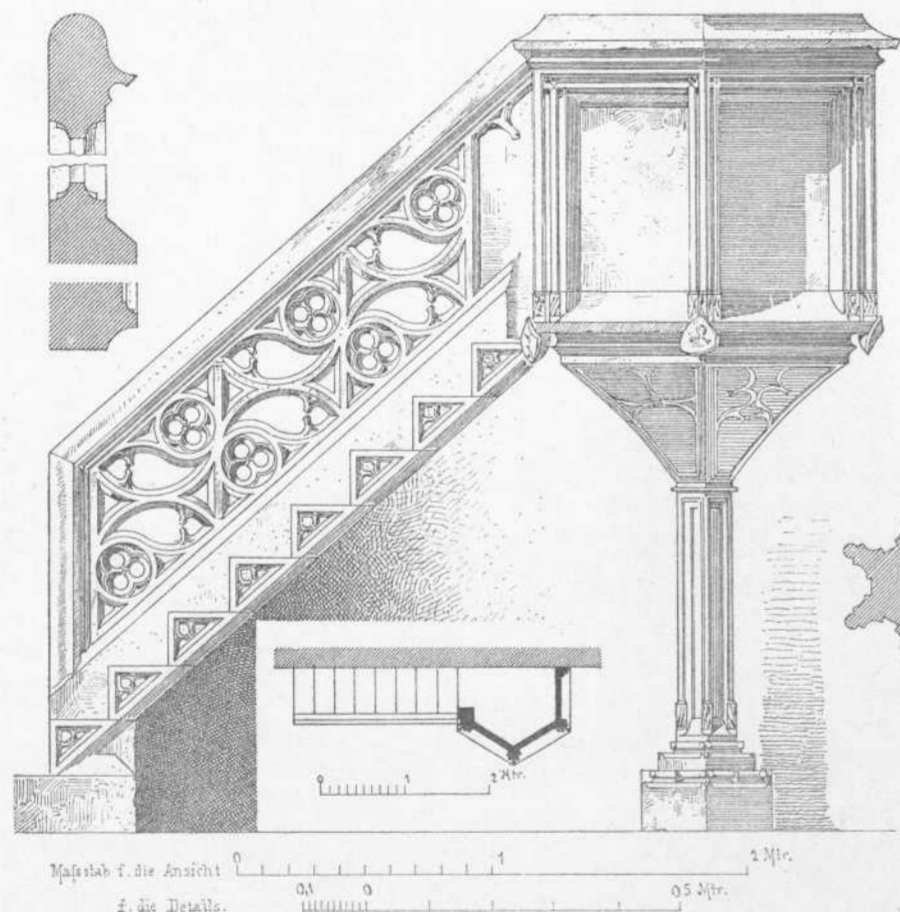

Maßstab f. die Ansicht 0 0,5 1 2 Mtr.
f. die Details.

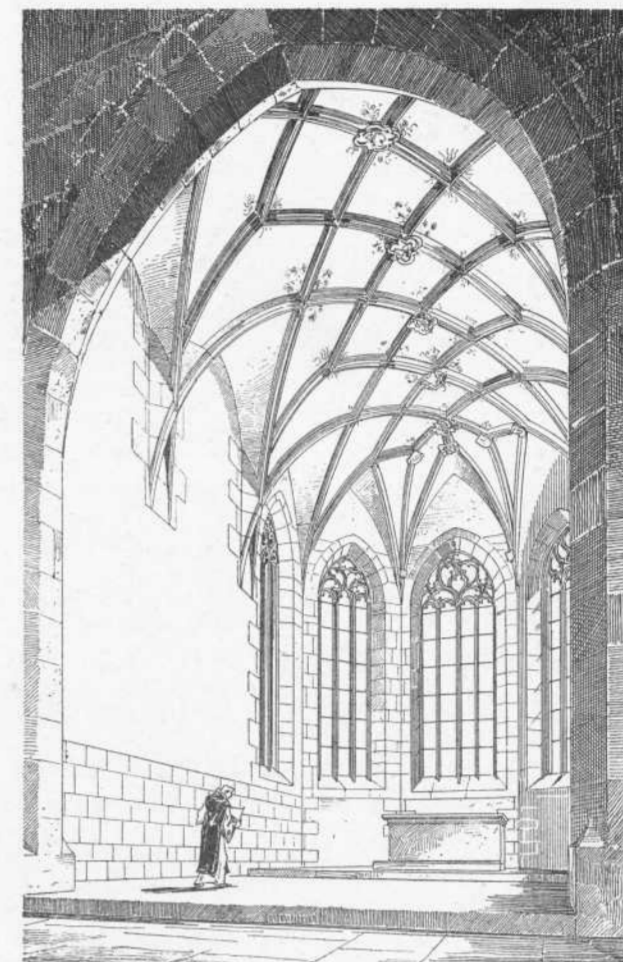
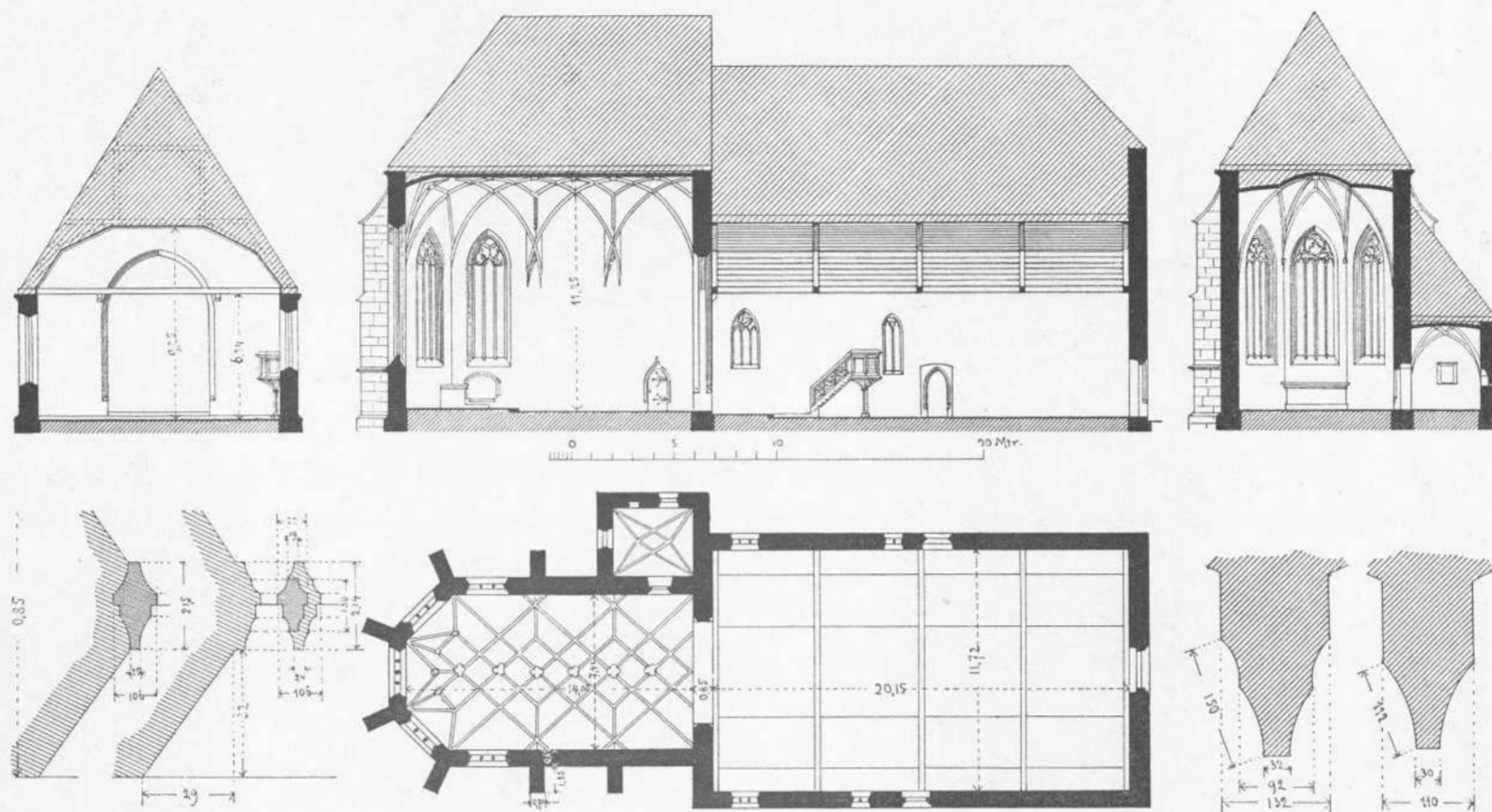
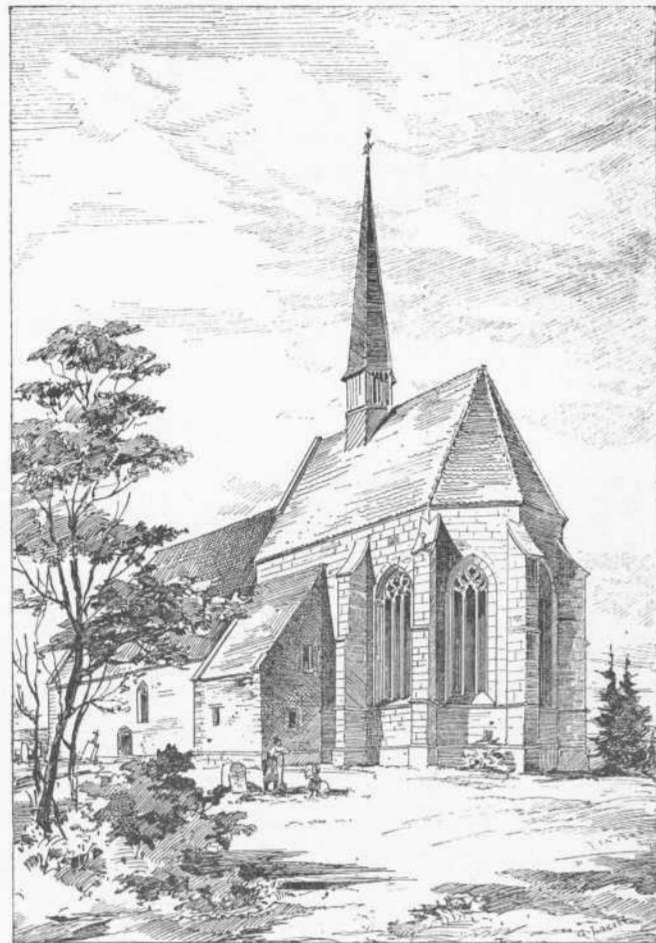
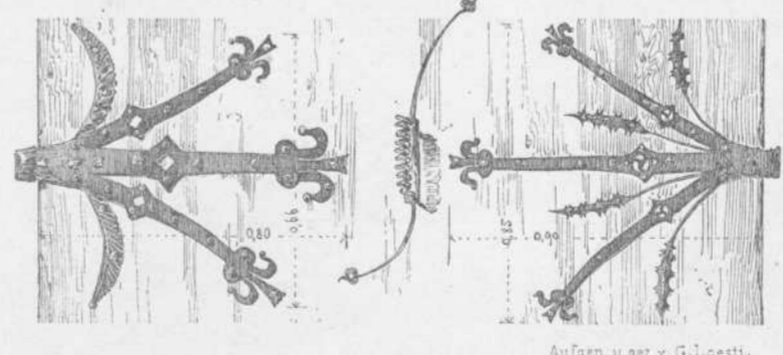
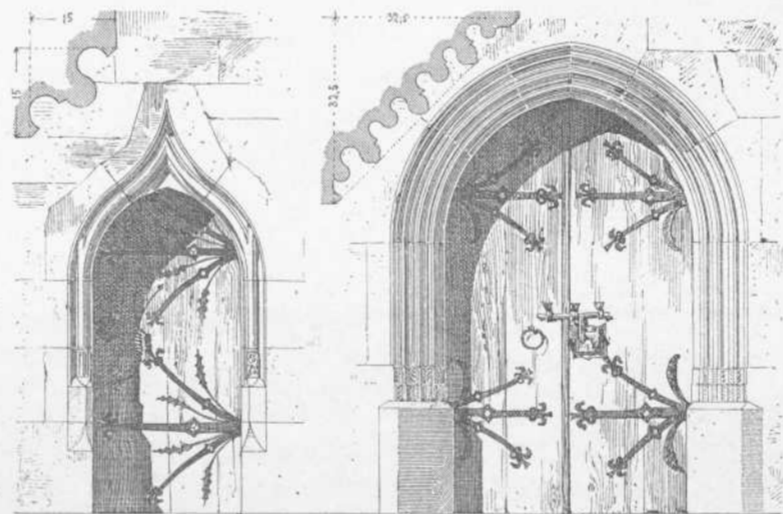

Aufg. u. ger. v. G. Loest.

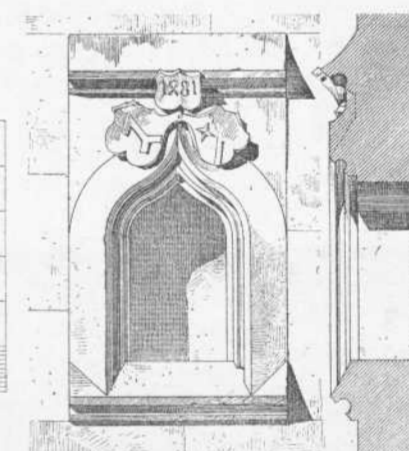
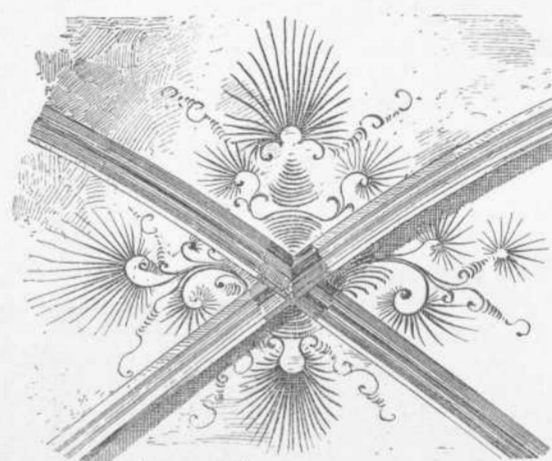

Neckarkreis.

Liebfrauenkirche bei Lienzingen.

O. A. Maulbronn.